

(Puente de Vallecas)

Ref: ONM2206005



## *New building (work) for sale in calle Robles (Madrid)*

New development next to Puente de Vallecas. The building has a total of 29 flats with 1 and 2 bedrooms, with communal garden and terrace on the ground floor, as well as parking and storage room in basements 1 and 2. In the area you can find: schools, hospitals, sports centres and shops. All the properties include storage room and parking spaces for optional purchase, with a price of 19.500 €. Main features: Reinforced entrance door / fitted wardrobes / aluminium exterior carpentry, with thermal break, double glazing with air chamber and blinds on all windows / false ceiling throughout the house / underfloor heating and cooling / laminate wood flooring / bathrooms with porcelain stoneware floor and tiling, with washbasin with vanity unit / kitchen with artificial stone worktop / garden / storage room / garage.

Madrid / Puente de Vallecas

Unit bj a

Completion Q4 2024

### **FEATURES**

Surface 52 m<sup>2</sup>

2 Rooms

1 Toilets

- ✓ Heating
- ✓ Boxroom
- ✓ AACC
- ✓ Backyard
- ✓ Lift
- ✓ Has parking

**PRICE UPON REQUEST**

(Puente de Vallecas)

Ref: ONM2206005

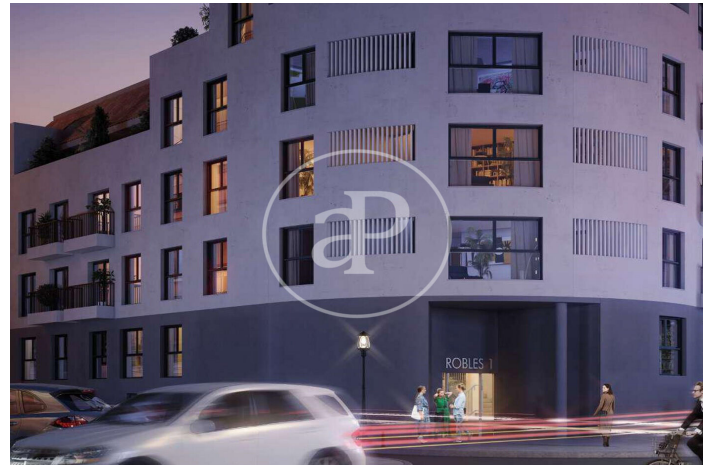

The information about any property is not binding to any offer or contract. Any verbal or written declaration made by aProperties with regards to the value or condition of the property should not be considered accurate or factual. The pictures make reference to some parts of the property at the times that they were taken. The areas, dimensions and distances that are given are approximate and should be checked by the client. The images are computer generated and are just an approximate indication of the real appearance of the property; these may change at any time. The information with regards to the property may also change at any time.

Contact us today for more information or to arrange a viewing

Tel: 91 800 54 65 [apropertiesmadrid@aproperties.es](mailto:apropertiesmadrid@aproperties.es) <https://www.aproperties.es>