

(Pelaire)

Ref: ONPM2110003

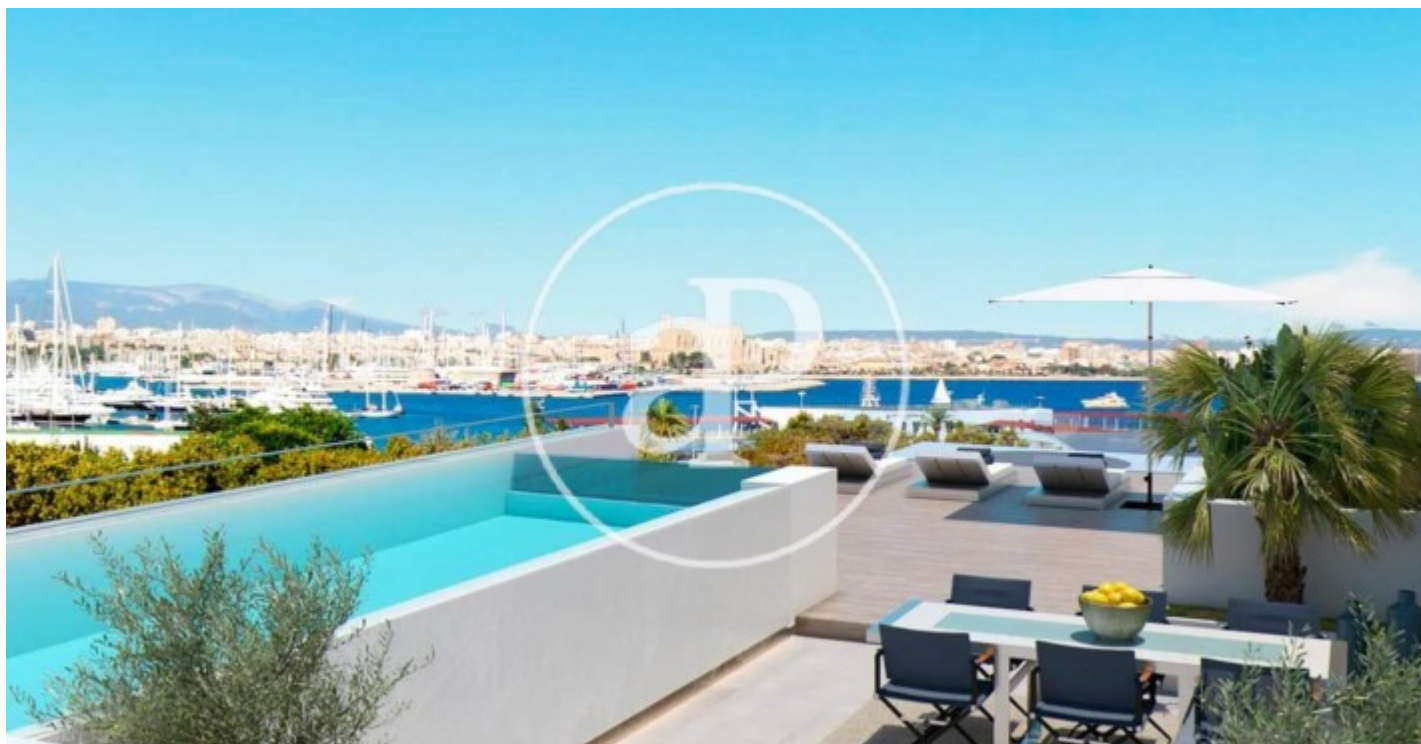

## *Promotion of New Construction with Views of Palma Marina*

On Paseo Marítimo de Palma, located in front of the Mediterranean Sea near the Club of its marina, this residential complex of only 15 units is located. This exclusive new development combines exceptional design, fantastic views and high quality materials. The apartments offer spacious common areas with terraces with panoramic views, an outdoor pool, a spa with gym, sauna and indoor pool. In addition, the complex offers a large underground car park spread over 3 levels that can be accessed directly by elevator from the apartments and, by car, from the street, except on level -3, which is accessed by a vehicle lift. Through the large windows of all the apartments you can enjoy the natural light of the Coast and excellent views of the sea, the Port and the Cathedral of the city, in the first line of its seafront. The asymmetrical shape of the building is characterized by the combination of the glass facade and a stone cladding. The structure gives each apartment absolute privacy and its owners a spectacular view. The apartments have their own terrace, a high-quality designer kitchen, built-in wardrobes, underfloor heating, hot / cold air conditioning, home automation sys [...]

Palma de Mallorca / Pellaire

Unit 2 203

Completion Q2 2023

### **FEATURES**

Surface 116 m<sup>2</sup> / 70 m<sup>2</sup> terrace

2 Rooms

2 Toilets

- ✓ Views
- ✓ Heating
- ✓ Boxroom
- ✓ AACC
- ✓ Terrace
- ✓ Backyard
- ✓ Pool
- ✓ Gym
- ✓ Lift
- ✓ Has parking

Price 2,100,000 €

(Pelaires)

Ref: ONPM2110003

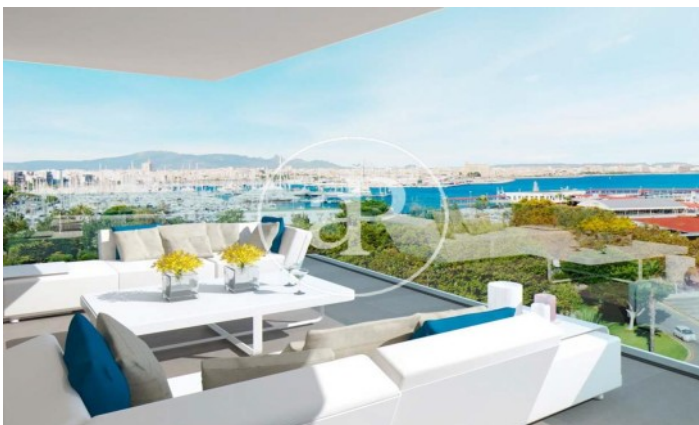
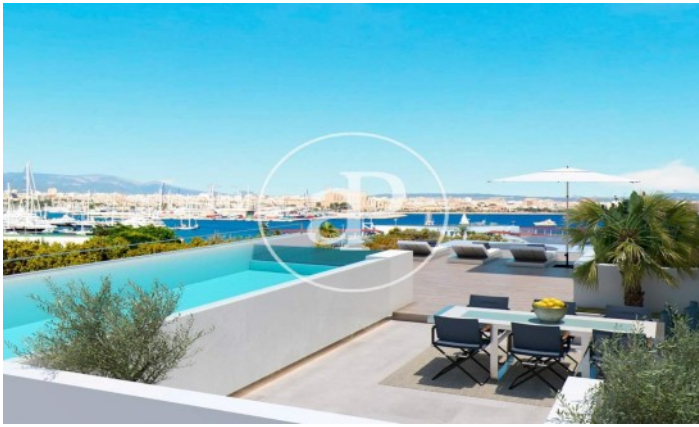

(Pelaires)

Ref: ONPM2110003

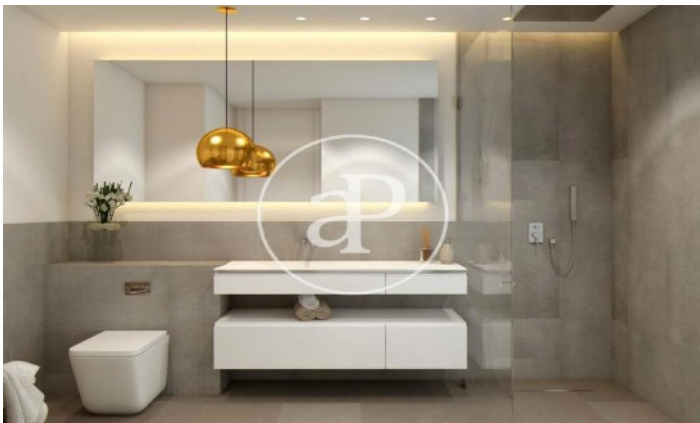

(Pelaires)

Ref: ONPM2110003



The information about any property is not binding to any offer or contract. Any verbal or written declaration made by aProperties with regards to the value or condition of the property should not be considered accurate or factual. The pictures make reference to some parts of the property at the times that they were taken. The areas, dimensions and distances that are given are approximate and should be checked by the client. The images are computer generated and are just an approximate indication of the real appearance of the property; these may change at any time. The information with regards to the property may also change at any time.

Contact us today for more information or to arrange a viewing

Tel: 871 16 01 60

[apropertiespalma@aproperties.es](mailto:apropertiespalma@aproperties.es)

<https://www.aproperties.es>